

**SAGOLA**  <sup>®</sup>  
an Elcometer company

**SERIE**  
**5000S**

# AIR TREATMENT

*High technology and maximum reliability*



w w w . s a g o l a . c o m

**MAXIMUM AIR QUALITY**

Air from a compressor circulating through the network contains particles and solid impurities, water from the relative humidity of the suction air and burnt oil from the compressor.

All these impurities accompanied by compressed air reach the vital parts of tools causing oxidation and premature wear.

**MINIMUM PRESSURE LOSS WITHIN THE LINE**

For these reasons it is necessary to eliminate impurities by means of a filter, taking into account that the maximum performance with the minimum pressure loss must be obtained.

**SAGOLA FILTRATION SYSTEMS guarantee the maximum air quality and the minimum pressure loss throughout the line.**

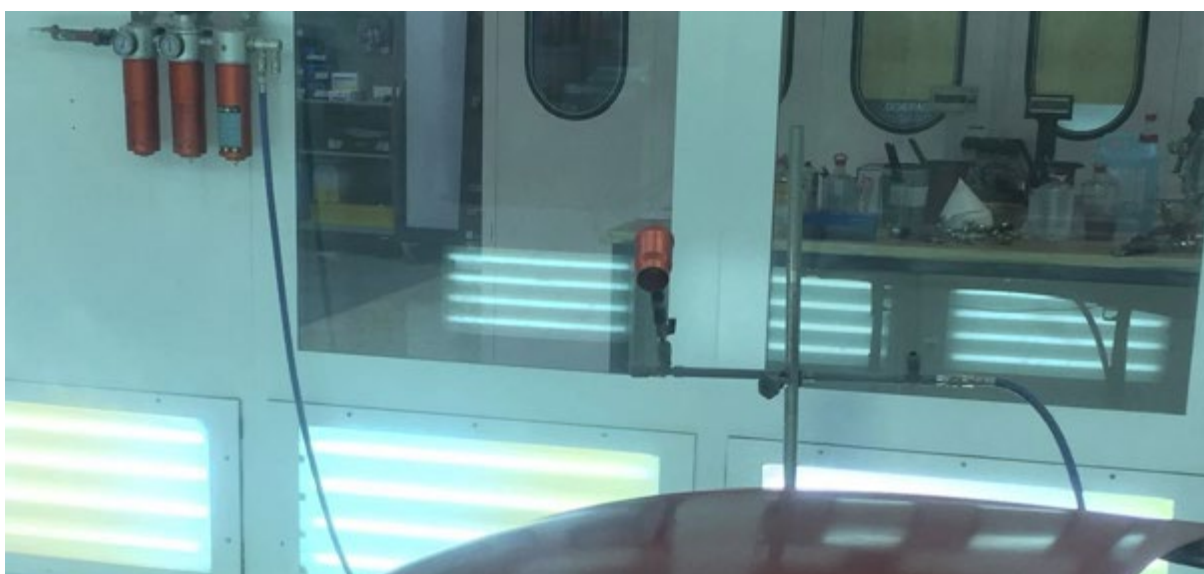

**EXTREMELY SMOOTH ACTION**

**MAXIMUM PRECISION**

- Air-assisted REGULATOR
- RAPID DISCHARGE; instant pressure reduction
- Aluminium body. CNC MACHINED FOR TOUGHNESS.
- UNMANNED DISCHARGE of liquids and impurities
- Maximum flow: 2,500 L/min, outlets for 2 guns
- 8u FILTER + high solid retention deflector + liquids
- 1/2 inch inlet
- FILTER LIFE CONTROL. We incorporate dynamic element of life control.

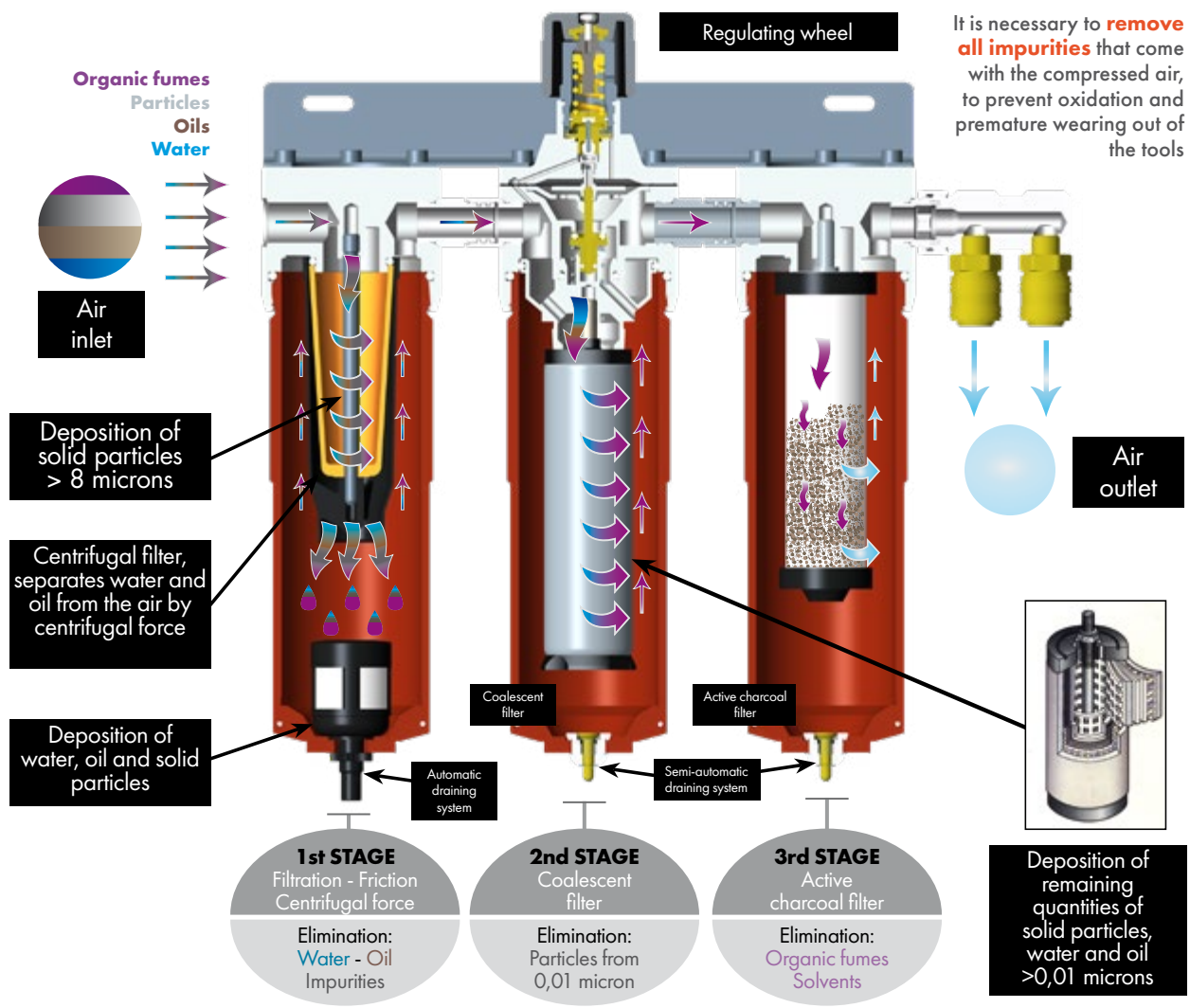

**Maximum painting quality. Retention of 99% of solids**

**Breathable air**

**Retention of solvents**

**Waterborne paints**

**Stainless steel couplings**

**Wide surface filters, maximum flow with the minimum maintenance.**

**Machined aluminium vessels; maximum finish quality and durability.**

**Push connectors with stainless steel mechanisms and silicon-free gaskets.**

**BIG ADVANTAGES**

Keys for the correct election of the filter

The type and condition of the installed compressor and the quality of the air it is supplying must be taken into account for the election of a filtration system to install.

For example, If greater air purity is required a model **5200X Coalescent Purifier Regulator** should be installed, with which the following will be eliminated water and solid particles larger than 0.01 microns, Water aerosols ( $C > 0.01 \text{ mg/m}^3$ ), Oil aerosols ( $C > 0.01 \text{ mg/m}^3$ )— or a purifier regulator with coalescent filter plus active charcoal **model 5300X** —used when it is necessary to eliminate oil, hydrocarbons or water in vapour form , organic fumes are present, foul air, solid particles larger than 0.01 microns and residual oil: maximum 0.003 ppm—.

SERIES  
 X00005

**Purifying Regulator Filter**  
with coalescent filter  
(0,01 micron) + wide surface  
active charcoal



MODEL	5300X Filter
Characteristics	Offers the maximum filtration level in spray booths painting lines where finishing is highly demanding. Sinterised brass 8 micron pre filtration is incorporated, followed by a 0.01 micron coalescent filter and final filtration by a wide surface active charcoal filter. This process eliminates, in addition to water and impurities, organic fumes and foul air. Ideal for waterborne paint lines and where organic fumes in the network are a problem.
Technical Data	Air Flow: 2.500 L/min. Air inlet: 1/2" BSP Air outlet: 3/8" BSP Maximum working pressure: 12 bar. Maximum temperature resistance 120°C. Automatic drain + 2 semi-automatic systems

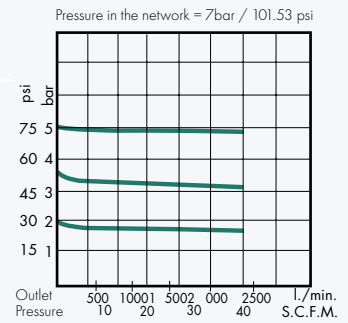

**The latest technology in air filtration**  
2 air purifying stages, mechanical and  
coalescent, a pressure regulator and a line  
pressure gauge.



MODEL	5200X Filter
Characteristics	Self-draining system and the assisted regulator wheel. Incorporates an 8 micron sinterised brass filter, followed by a final 0.01 micron coalescent filter. It has 2 outlets allowing you to use two tools at once. Its new vessels are tougher and more protective. its new draining system reduces maintenance costs due to its greater durability. It carries out double filtration with optimum flow and pressure regulation, retention of water and impurities attaining an air purity of 99%.
Technical Data	Air Flow: 2.500 L/min. Air inlet: 1/2" BSP Air outlet: 3/8" BSP Maximum working pressure: 12 bar. Maximum temperature resistance 120°C.

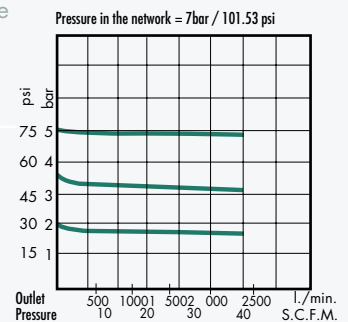

## Filters SAGOLA High Range

### Air purifying filter with pressure regulator and a pressure gauge



MODEL	<b>5100X Filter</b>
Characteristics	<p>Friction and centrifuged filtering. Incorporate 8 micron sinterised brass filter. Its triple filtration system retains water and impurities. It has 2 outlets allowing you to use two tools at once.</p> <p>Its NEW VESSEL is tougher and more protective. Comes with a NEW DRAINING SYSTEM which reduces maintenance costs due to its greater durability. Valid for HS paints and highest quality finishes. Self-draining system and assisted regulator wheel.</p>
Technical Data	<p>Air Flow: 2.500 L/min.                  Air inlet: 1/2" BSP                  Air outlet: 1/4" BSP                  Maximum working pressure: 12 bar.                  Maximum temperature resistance 180°C.                  Automatic drain system</p>

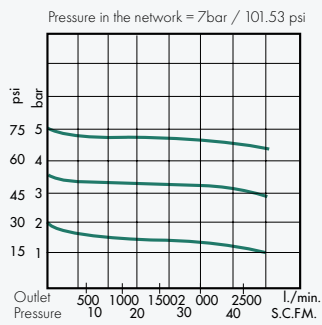

### Valid for highest quality finishes Air purifying filter with pressure regulator and a pressure gauge



MODEL	<b>5000X Filter</b>
Characteristics	<p>Incorporates a semi-automatic draining system.</p> <p>Its NEW VESSEL is tougher and more protective.</p> <p>Retains water, oil and other impurities.</p> <p>Membrane mechanical regulator with great robustness.</p> <p>Extremely smooth action.</p> <p>Friction and centrifuged filtering.</p> <p>Incorporate 40 micron sinterised brass filter.</p>
Technical Data	<p>Air Flow: 2.500 L/min.                  Air inlet: 1/2" BSP                  Air outlet: 1/4" BSP                  Maximum working pressure: 12 bar.                  Maximum temperature resistance 180°C.                  Semi-automatic drain system</p>

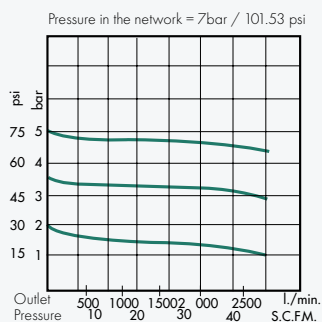

# SAGOLA WARRANTY

SAGOLA warranty against manufacturing or design defects of its range for the period of **3 years**. This warranty covers replacement or repair of the product.



# SAGOLA SPARES WARRANTY SERVICE

SAGOLA is committed to **high-quality and service**. For this reason SAGOLA provides with a warranty spares service for products supplied over the past 10 years.

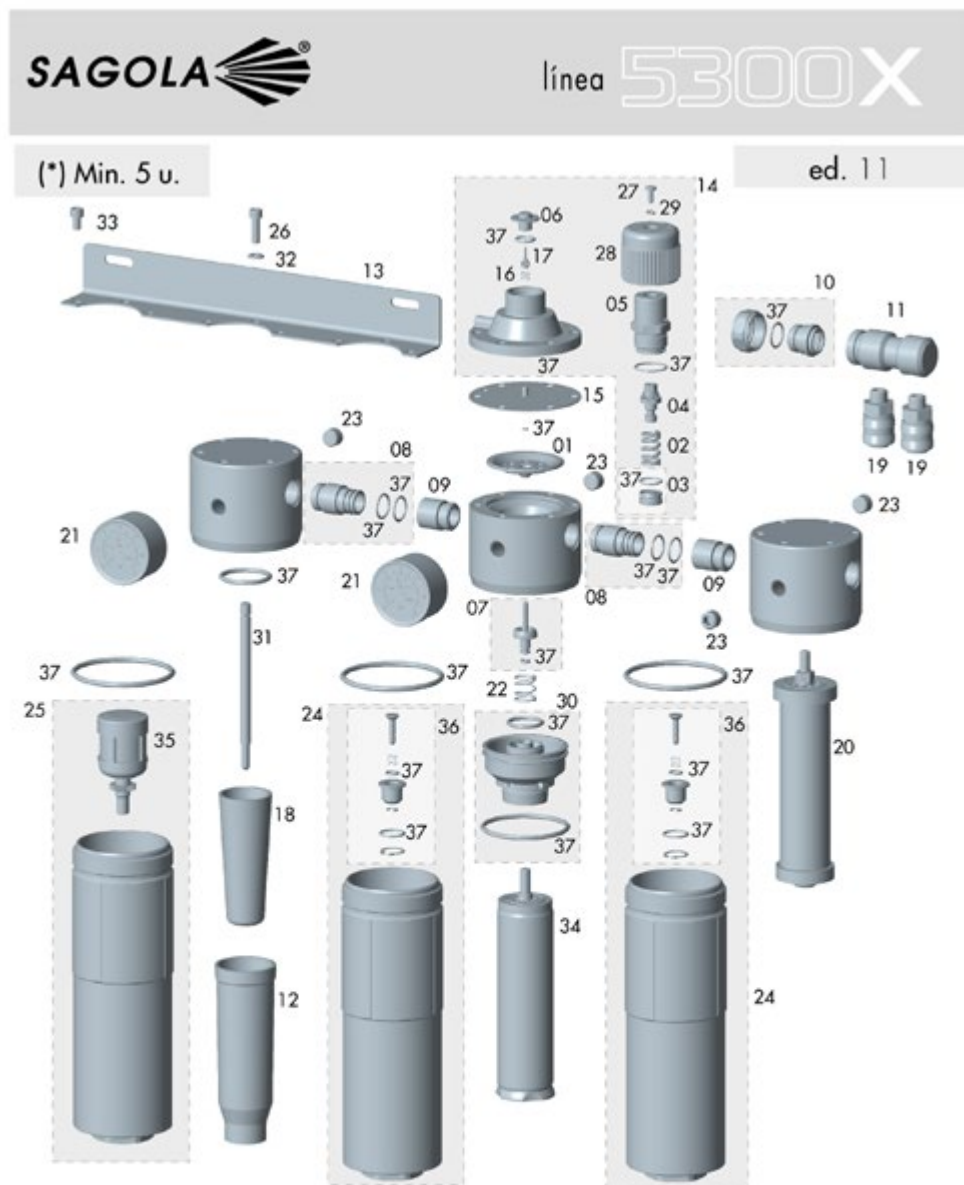

N°	Cod.	U.	N°	Cod.	U.	N°	Cod.	U.	N°	Cod.	U.	N°	Cod.	U.
01	52910002	1	09	55710234	2	17	56417409	1	25	56417705	1	33	57250816	4
02	54710249	1	10	56410048	1	18	56418719	1	26	57250817	6	34	56418071	1
03	56410034	1	11	55710509	1	19	11010531	2	27	57251305	1	35	56450010	1
04	56417903	1	12	52713106	1	20	56418070	1	28	57810329	1	36	56418533	2
05	52713019	1	13	53310207	1	21	54550016	2	29	80860703	1	37	56418537	1
06	52910402	1	14	56410047	1	22	54710250	1	30	56310611	1			
07	56417405	1	15	56418562	1	23	55752117	4	31	57211914	1			
08	56414914	2	16	54710206	1	24	56417704	2	32	50850402	3			

• Este dibujo no es la lista de materiales  
 • This drawing is not the bill of materials  
 • Ce schéma n'est pas la liste de matériaux

• Diese Zeichnung ist nicht die Stückliste  
 • Este desenho não é a lista de materiais  
 • Questo disegno non è la distinta base

## FILTER LIFE

The **filters** of your unit have a **limited life**. After it, when filters become clogged, the equipment performance may decrease. Therefore, we have no guarantee of 100% correct filtering.

This is the **average life** of each of the filters of your unit:



Ref. 536 102 07  
BRASS FILTER

Ref. 564 180 71  
COALESCENT FILTER

Ref. 564 180 70  
ACTIVE CHARCOAL FILTER

- **Non-intensive use.**
- Compressor air of high quality.



- **Intensive use.**
- Compressor air of high quality.
- Use as a supply of breathable air.



**OPTIMAL AIR QUALITY**

### Filter life controller

For ease of **control life** of the filters on your unit, filter vessels has placed a dynamic device readable.

These reading elements are **adhesive** and **single-use**.

When you start using the filter you must press the "ON" button  on the device.



### Regulations / Patents / Registries

- All SAGOLA products comply with the strictest safety standards for the manufacturing of painting equipment. SAGOLA products comply with EC regulations and all the ATEX standards.
- To protect itself against copies and counterfeits, SAGOLA registers the shape of its guns and naturally registers its trademark worldwide.

**X**  
**5000**  
**SERIES**

**SAGOLA**  
an Elcometer company

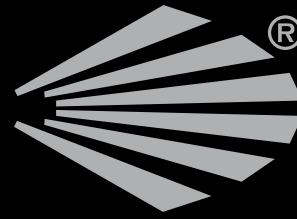

SAGOLA S.A. will refuse any responsibility for the damage of defects caused by filtering system a similar appearance to the originals. These filtering systems are imitations that **HAVE NOT BEEN MANUFACTURED BY SAGOLA, S.A.** The SAGOLA S.A. products are exclusively sold through our distributors, with spare parts and a 3-year worldwide guarantee against manufacturing defects.



**ISO CERTIFICATES**



SAGOLA S.A. has always displayed the quality of its products with pride, but lately, in view of its ever more demanding clients, it has obtained certifications that vouch for the guarantee of its know-how and its impeccable organisational quality.

**MADE IN SPAIN**



**SAGOLA, S.A.U.**

Urartea, 6  
01010 · Vitoria - Gasteiz  
(Álava) SPAIN  
Tel.: (+34) 945 214 150  
Fax: (+34) 945 214 147  
sagola@sagola.com  
www.sagola.com